

# H5300-13'

## CH 5100, 5300

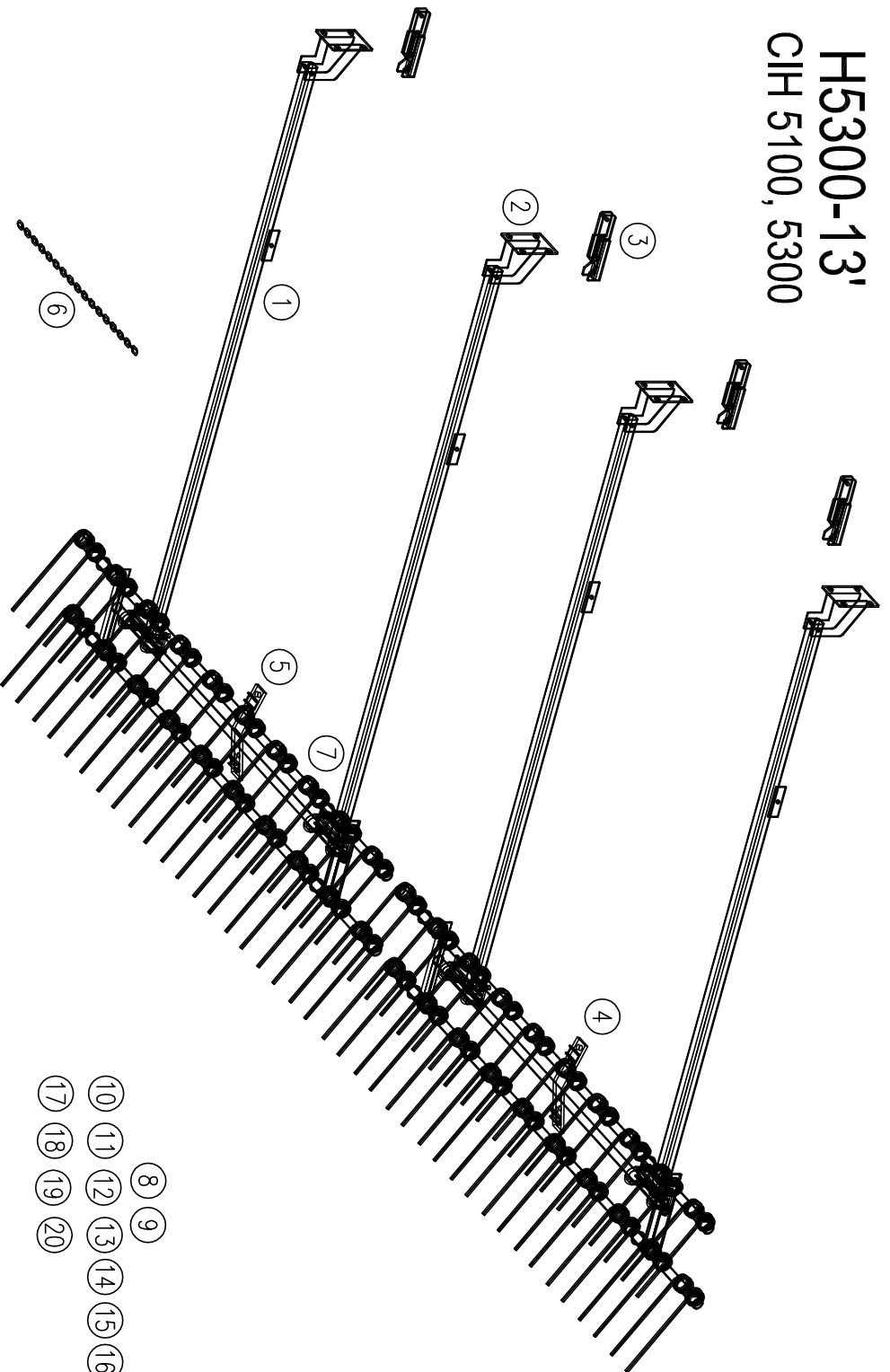

#	Description	Part #	Quan
1	PULL BAR, CH 5100, 5300	H10024-00	4
2	PULL BRACKET, CH 5300	H10025-00	4
3	LEVER, CH 5300	H10026-00	4
4	HARROW SECT. ASM., 6.5' RH O/S	H10056-00	1
5	HARROW SECT. ASM., 6.5' LH O/S	H10057-00	1
6	3/16" X 30" PRF COLL CHAIN	H10063-01	4
7	1/2" U-bolt for Schlüter Harrow	H715	8
8	1/2" LOCK WASHER	-	16
9	HEX NUT 1/2-13	-	16
10	3/8" x 2 3/4" BOLT	-	4

#	Description	Part #	Quan
11	3/8" NYLOK	-	4
12	U-BOLT	815284C1	4
13	3/8" X 1" BOLT	-	16
14	3/8" LOCK WASHER	-	24
15	3/8" FLAT WASHER	-	16
16	3/8-16 HEX NUT	-	24
17	5/16-18 X 1" BOLT	-	4
18	5/16-18 X 1 1/2" BOLT	-	4
19	5/16" FLAT WASHER	-	4
20	5/16" NYLOK	-	8

- (8) (9)  
 (10) (11) (12) (13) (14) (15) (16)  
 (17) (18) (19) (20)