

H1850-30'-2

1850 Air Seeder

(Dual Gang w/Pull Cart)

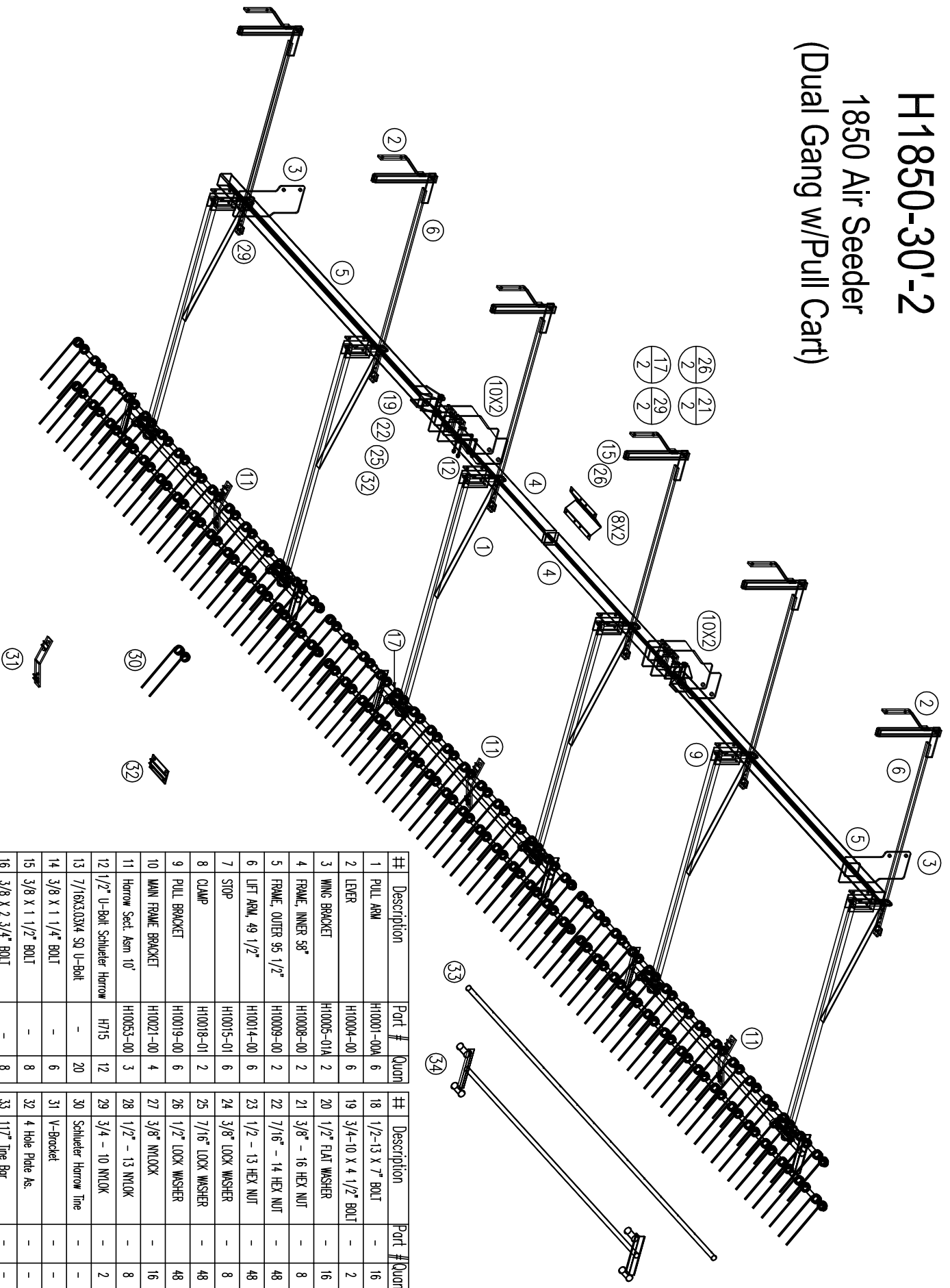

##	Description	Part #	Quan	##	Description	Part #	Quan
1	PULL ARM	H10001-00A	6	18	1/2-13 X 7" BOLT	-	16
2	LEVER	H10004-00	6	19	3/4-10 X 4 1/2" BOLT	-	2
3	WING BRACKET	H10005-01A	2	20	1/2" FLAT WASHER	-	16
4	FRAME, INNER 58"	H10008-00	2	21	3/8" - 16 HEX NUT	-	8
5	FRAME, OUTER 95 1/2"	H10009-00	2	22	7/16" - 14 HEX NUT	-	48
6	LFT ARM, 49 1/2"	H10014-00	6	23	1/2 - 13 HEX NUT	-	48
7	STOP	H10015-01	6	24	3/8" LOCK WASHER	-	8
8	CLAMP	H10018-01	2	25	7/16" LOCK WASHER	-	48
9	PULL BRACKET	H10019-00	6	26	1/2" LOCK WASHER	-	48
10	MAIN FRAME BRACKET	H10021-00	4	27	3/8" NUTLOCK	-	16
11	Harrow Sect. Asm 10'	H10053-00	3	28	1/2" - 13 NUTLOCK	-	8
12	1 1/2" U-Bolt Schueler Harrow	H715	12	29	3/4 - 10 NUTLOCK	-	2
13	7/16X3.03X4 SQ U-Bolt	-	20	30	Schueler Harrow Tine	-	-
14	3/8 X 1 1/4" BOLT	-	6	31	V-Bracket	-	-
15	3/8 X 1 1/2" BOLT	-	8	32	4 Hole Plide As.	-	-
16	3/8 X 2 3/4" BOLT	-	8	33	117" Tine Bar	-	-
17	1/2-13 X 2" BOLT	-	8	34	81" Cross Bar	-	-

H1850-30-2MASTER.DWG