

# H1690-40'-1

## 1690/1990 CCS Air Seeder (Single Gang)

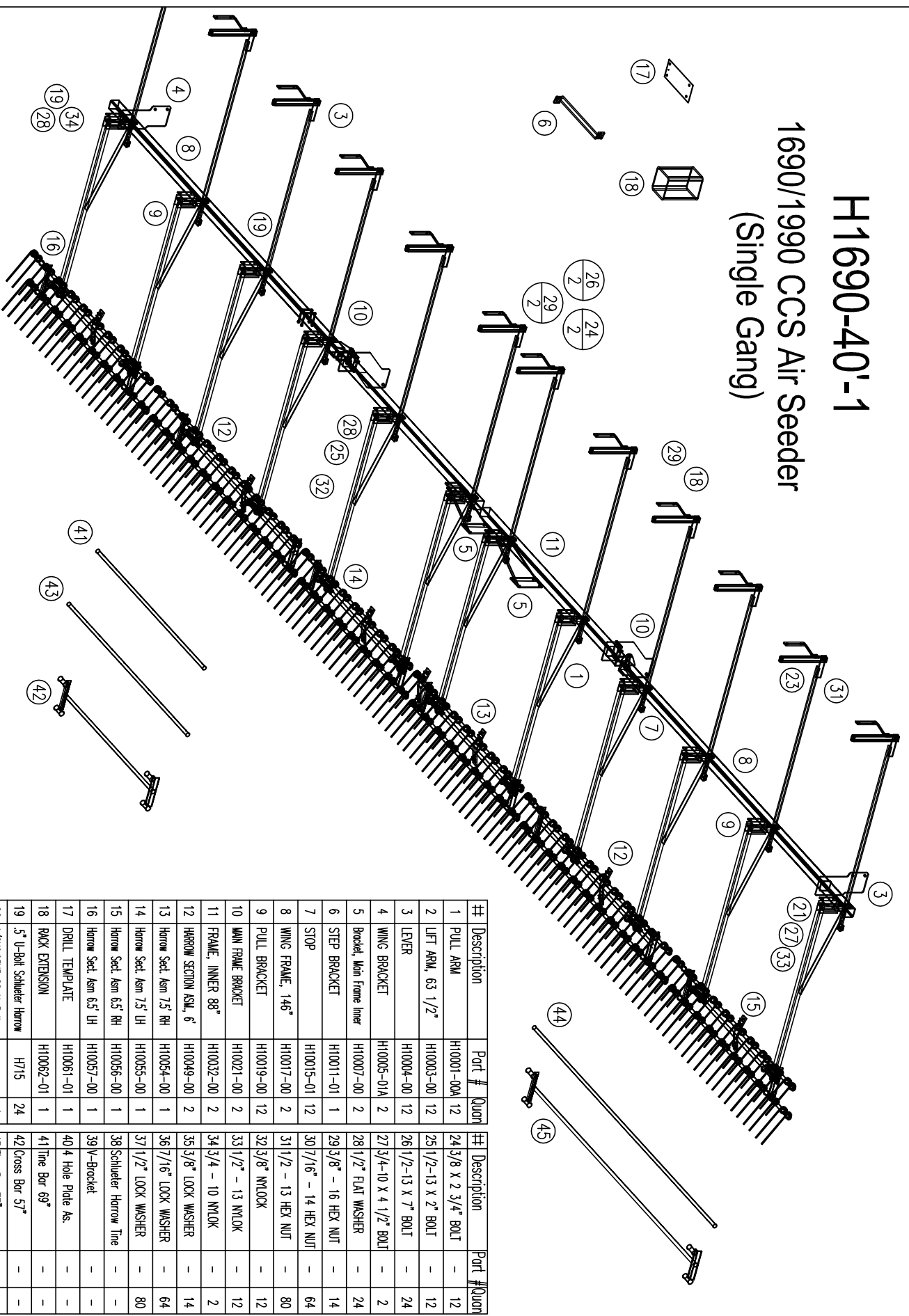

#	Description	Part #	Quan	#	Description	Part #	Quan
1	PULL ARM	H10001-00A	12	24	3/8 X 2 3/4" BOLT	-	12
2	LIFT ARM, 63 1/2"	H10003-00	12	25	1/2-13 X 2" BOLT	-	12
3	LEVER	H10004-00	12	26	1/2-13 X 7" BOLT	-	24
4	WING BRACKET	H10005-01A	2	27	3/4-10 X 4 1/2" BOLT	-	2
5	Bracket, Main frame liner	H10007-00	2	28	1/2" FLAT WASHER	-	24
6	STEP BRACKET	H10011-01	1	29	3/8" - 16 HEX NUT	-	14
7	STOP	H10015-01	12	30	7/16" - 14 HEX NUT	-	64
8	WING FRAME, 146"	H10017-00	2	31	1/2" - 13 HEX NUT	-	80
9	PULL BRACKET	H10019-00	12	32	3/8" NYLOCK	-	12
10	MAIN FRAME BRACKET	H10021-00	2	33	1/2" - 13 NYLOCK	-	12
11	FRAME, INNER 88"	H10032-00	2	34	3/4" - 10 NYLOCK	-	2
12	HARROW SECTION ASM, 6'	H10049-00	2	35	3/8" LOCK WASHER	-	14
13	Harrow Sect. Asm 7.5' RH	H10054-00	1	36	7/16" LOCK WASHER	-	64
14	Harrow Sect. Asm 7.5' LH	H10055-00	1	37	1/2" LOCK WASHER	-	80
15	Harrow Sect. Asm 6.5' RH	H10056-00	1	38	Schlietter Harrow Tine	-	-
16	Harrow Sect. Asm 6.5' LH	H10057-00	1	39	V-Bracket	-	-
17	DRILL TEMPLATE	H10061-01	1	40	4 Hole Plate As.	-	-
18	RACK EXTENSION	H10062-01	1	41	Tine Bar 69"	-	-
19	5" U-Bolt Schlietter Harrow	H715	24	42	Cross Bar 57"	-	-
20	1/2x6.03x5 SQ U-Bolt	-	4	43	Tine Bar 77"	-	-
21	7/16x3.03x4 SQ U-Bolt	-	32	44	Tine Bar 93"	-	-
22	3/8 X 1" BOLT	-	2	45	Cross Bar 73"	-	-
23	3/8 X 1 1/4" BOLT	-	12				