

H1690-36'-1

1690/1990 CCS Air Seeder (Single Rank)

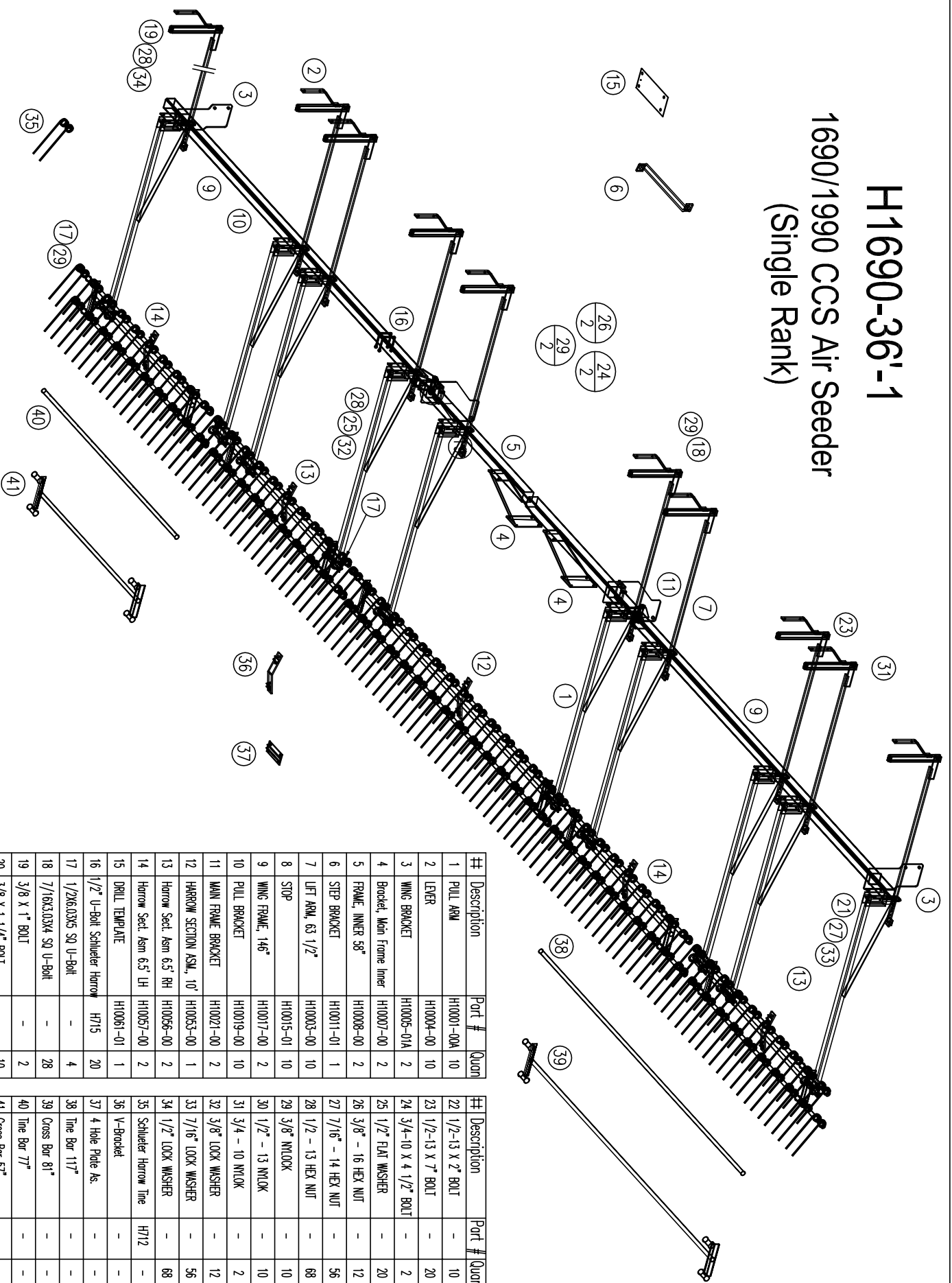

##	Description	Part #	Quan	##	Description	Part #	Quan
1	PULL ARM	H10001-00A	10	22	1/2-13 X 2" BOLT	-	10
2	LEGER	H10004-00	10	23	1/2-13 X 7" BOLT	-	20
3	WING BRACKET	H10005-01A	2	24	3/4-10 X 4 1/2" BOLT	-	2
4	Bracket, Main frame inner	H10007-00	2	25	1/2" FLAT WASHER	-	20
5	FRAME, INNER 58"	H10008-00	2	26	3/8" - 16 HEX NUT	-	12
6	STEP BRACKET	H10011-01	1	27	7/16" - 14 HEX NUT	-	56
7	LIFT ARM, 63 1/2"	H10003-00	10	28	1/2 - 13 HEX NUT	-	88
8	STOP	H10015-01	10	29	3/8" NUTLOCK	-	10
9	WING FRAME, 146"	H10017-00	2	30	1/2" - 13 NUTLOCK	-	10
10	PULL BRACKET	H10019-00	10	31	3/4 - 10 NUTLOCK	-	2
11	MAIN FRAME BRACKET	H10021-00	2	32	3/8" LOCK WASHER	-	12
12	HARROW SECTION ASM., 10'	H10053-00	1	33	7/16" LOCK WASHER	-	56
13	Harrow Sect. Asm 6.5" RH	H10056-00	2	34	1/2" LOCK WASHER	-	88
14	Harrow Sect. Asm 6.5" LH	H10057-00	2	35	Schlieder Harrow Tine	H712	-
15	DRILL TEMPLATE	H10061-01	1	36	V-Bracket	-	-
16	1/2" U-Bolt Schlieder Harrow	H715	20	37	4 Hole Plate As.	-	-
17	1/2x6.03x5 SQ U-Bolt	-	4	38	Tine Bar 117"	-	-
18	7/16x3.03x4 SQ U-Bolt	-	28	39	Cross Bar 81"	-	-
19	3/8 X 1" BOLT	-	2	40	Tine Bar 77"	-	-
20	3/8 X 1 1/4" BOLT	-	10	41	Cross Bar 57"	-	-
21	3/8 X 2 3/4" BOLT	-	10				