

H1690-30'-2

1690/1990 CCS Air Seeder

(Dual Rank)

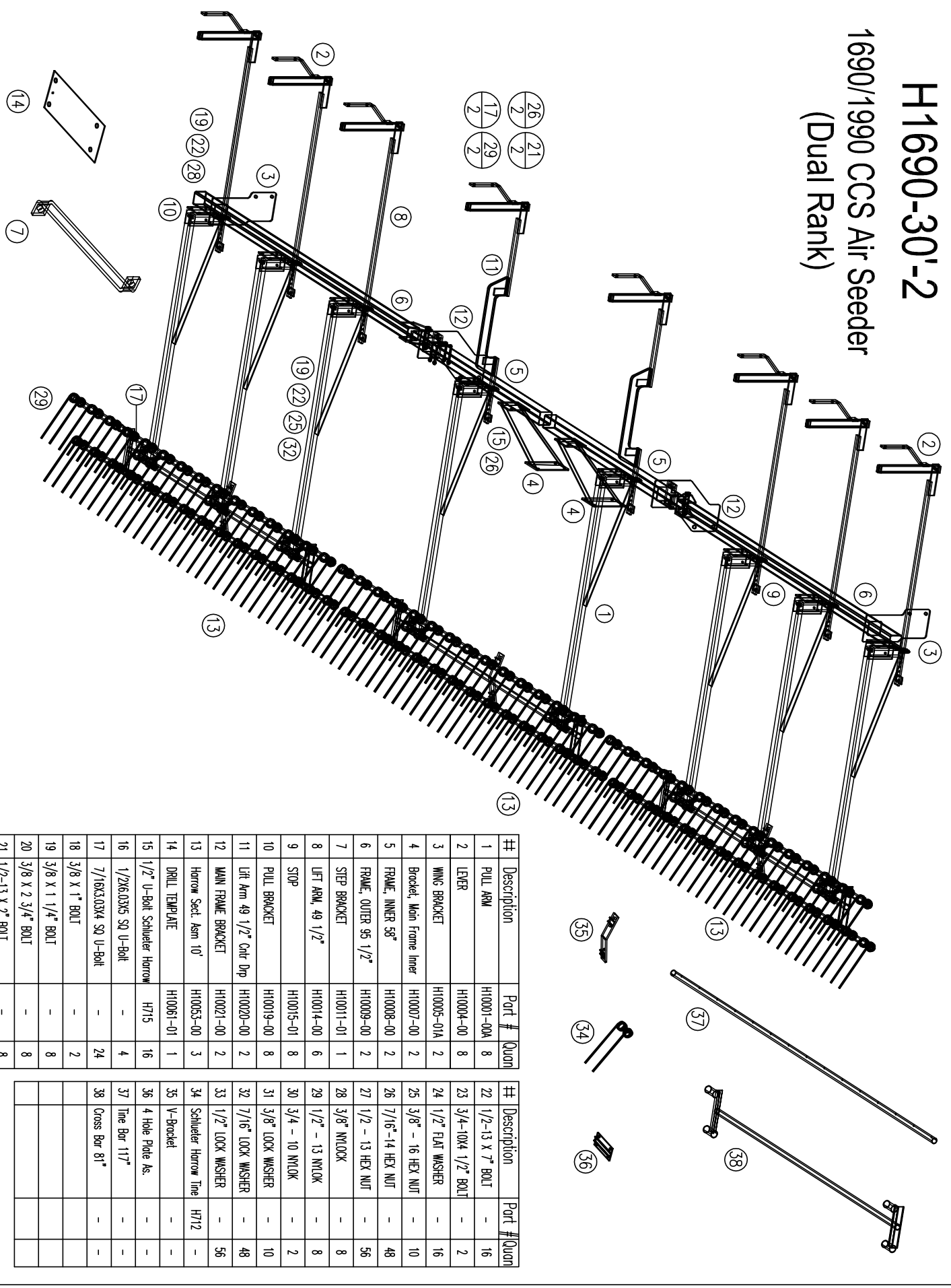

##	Description	Part #	Quan
1	PULL ARM	H10001-00A	8
2	LEVER	H10004-00	8
3	WING BRACKET	H10005-01A	2
4	Bracket, Main Frame Inner	H10007-00	2
5	FRAME, INNER 58"	H10008-00	2
6	FRAME, OUTER 95 1/2"	H10009-00	2
7	STEP BRACKET	H10011-01	1
8	LIFT ARM, 49 1/2"	H10014-00	6
9	STOP	H10015-01	8
10	PULL BRACKET	H10019-00	8
11	Lift Arm 49 1/2" Cnt Dnp	H10020-00	2
12	MAIN FRAME BRACKET	H10021-00	2
13	Harrow Sect. Asm 10'	H10053-00	3
14	DRILL TEMPLATE	H10061-01	1
15	1/2" U-Bolt Schleier Harrow	H715	16
16	1/2X6.03X5 SQ U-Bolt	-	4
17	7/16X3.03X4 SQ U-Bolt	-	24
18	3/8 X 1" BOLT	-	2
19	3/8 X 1 1/4" BOLT	-	8
20	3/8 X 2 3/4" BOLT	-	8
21	1/2-13 X 2" BOLT	-	8

##	Description	Part #	Quan
22	1/2-13 X 7" BOLT	-	16
23	3/4-10X4 1/2" BOLT	-	2
24	1/2" FLAT WASHER	-	16
25	3/8" - 16 HEX NUT	-	10
26	7/16-14 HEX NUT	-	48
27	1/2 - 13 HEX NUT	-	56
28	3/8" NYLOCK	-	8
29	1/2" - 13 NYLOCK	-	8
30	3/4 - 10 NYLOCK	-	2
31	3/8" LOCK WASHER	-	10
32	7/16" LOCK WASHER	-	48
33	1/2" LOCK WASHER	-	56
34	Schleier Harrow Time	H712	-
35	V-Bracket	-	-
36	4 Hole Plate As.	-	-
37	Time Bar 117"	-	-
38	Cross Bar 81"	-	-