

H1690-30'-1

1690/1990 CCS Air Seeder

(Single Rank)

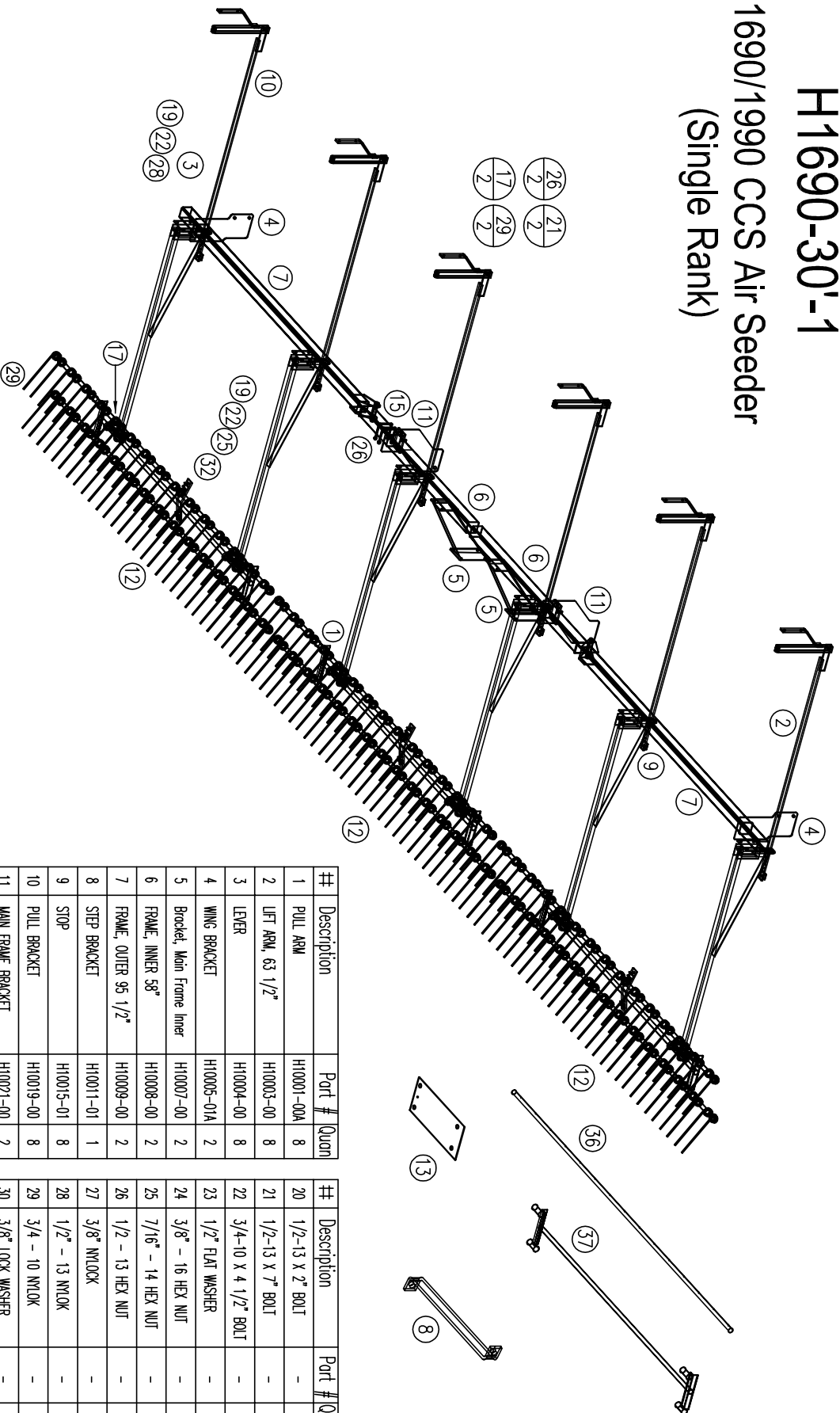

| ## | Description | Part # | Quom |
|----|------------------------------|------------|------|
| 1 | PULL ARM | H10001-00A | 8 |
| 2 | LIFT ARM, 63 1/2" | H10003-00 | 8 |
| 3 | LEVER | H10004-00 | 8 |
| 4 | WING BRACKET | H10005-01A | 2 |
| 5 | Bracket, Main Frame Inner | H10007-00 | 2 |
| 6 | FRAME, INNER 58" | H10008-00 | 2 |
| 7 | FRAME, OUTER 95 1/2" | H10009-00 | 2 |
| 8 | STEP BRACKET | H10011-01 | 1 |
| 9 | STOP | H10015-01 | 8 |
| 10 | PULL BRACKET | H10019-00 | 8 |
| 11 | MAIN FRAME BRACKET | H10021-00 | 2 |
| 12 | Harrow Sect. Asm 10" | H10053-00 | 3 |
| 13 | DRILL TEMPLATE | H10061-01 | 1 |
| 14 | 1/2" U-Bolt Schlieder Harrow | H715 | 16 |
| 15 | 1/2x6.03x5 SQ U-Bolt | - | 4 |
| 16 | 7/16x3.03x4 SQ U-Bolt | - | 24 |
| 17 | 3/8 x 1" BOLT | - | 2 |
| 18 | 3/8 x 1 1/4" BOLT | - | 8 |
| 19 | 3/8 x 2 3/4" BOLT | - | 8 |

| ## | Description | Part # | Quom |
|----|----------------------|--------|------|
| 20 | 1/2-13 x 2" BOLT | - | 8 |
| 21 | 1/2-13 x 7" BOLT | - | 16 |
| 22 | 3/4-10 x 4 1/2" BOLT | - | 2 |
| 23 | 1/2" FLAT WASHER | - | 16 |
| 24 | 3/8" - 16 HEX NUT | - | 10 |
| 25 | 7/16" - 14 HEX NUT | - | 48 |
| 26 | 1/2 - 13 HEX NUT | - | 56 |
| 27 | 3/8" W/LOCK | - | 8 |
| 28 | 1/2" - 13 N/LOCK | - | 8 |
| 29 | 3/4 - 10 N/LOCK | - | 2 |
| 30 | 3/8" LOCK WASHER | - | 10 |
| 31 | 7/16" LOCK WASHER | - | 48 |
| 32 | 1/2" LOCK WASHER | - | 56 |
| 33 | Schlieder Harrow Tie | H712 | |
| 34 | 4 Hole Pile As. | - | |
| 35 | V-Bracket | - | |
| 36 | Tine Bar 117" | - | |
| 37 | Cross Bar 81" | - | |